

1

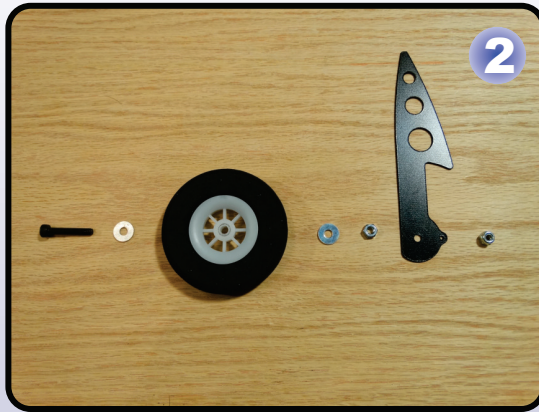

2

#1 - Inspect to insure that you have all the items shown.
 #2 - Order of assembly of items is as shown left to right. Note that the 2" wheel is not part of the kit and the LG strut will install in-between the Nylok nut to the right and the black G10 part.

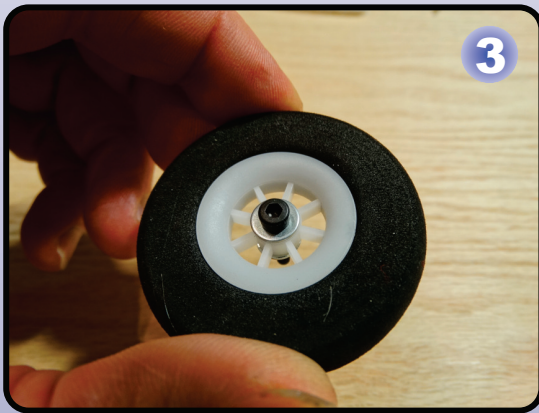

3

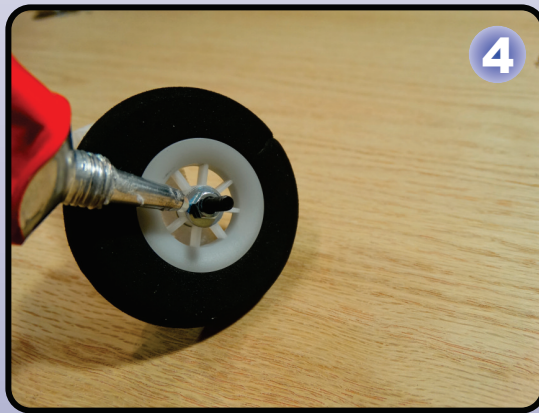

4

#3 - Install a screw and washer from the front side.
 #4 - From the back side of the assembly, install another washer and standard nut. Make sure the wheel still spins and apply a little thread locker or Welders to hold the nut in place.



5

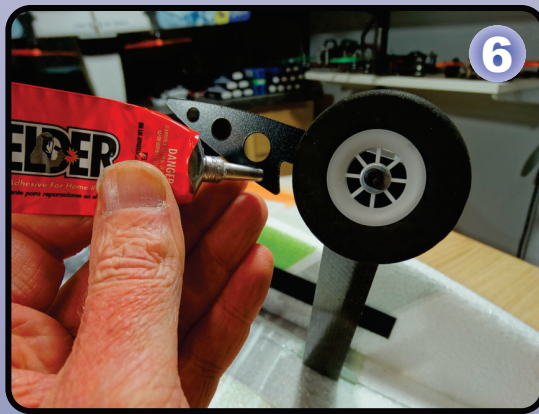

6

#5 - Slide the wheel assembly onto the black G10 part, and then thru the hole in the LG Strut, install the Nylok nut. Hold the screw & tighten the nut. Make sure the wheel still spins.
 #6 - Apply a skim coat of Welders to the G10 part as shown that will match up to the EPP part.



7



8

#7 - Position the EPP wheel pant so that there is about 1/16" clearance between it and the wheel, and that it is centered on the dia. of the wheel.
 #8 - Repeat for the other side and adjust position so that they are not too low on the back side and even with each other.